



## **SERIE III**

### **PRICING. / TECHNICAL DATA**





## Vessel Basic Prices

Optional features: Facelift III	Desk Plastic - Deck/Roof	Padding selection price class	TV 32` Smart LTE*	Thruster + Remote	AC	Incineration Toilette	Outside shower 6 liter hot water. 10 liter hot water	Solar 320W.	Lithium Board 2 <sup>nd</sup> Charger	Shading Isolated	Vessel Price Net EUR €
DepartureOne M Premium	D	1 (grey)	✓	180°		✓	6	1x	150Ah	✓	159.000
DepartureOne M Ultimate	D R	2	✓	360°	✓	✓	10	2x	300Ah, 2 <sup>nd</sup> C	✓	169.000
DepartureOne L/XL Premium	D	1 (gray)	✓	180°		✓	6	1x	150Ah	✓	179.000
DepartureOne L/XL Ultimate	D R	2	✓	360°	✓	✓	10	2x	300Ah, 2 <sup>nd</sup> C	✓	189.000

All prices for vessels and additional features and all particulars given in this brochure are non-binding customer information, delivery ex works.  
All prices apply to individual vessels and are valid from 2023 – subject to change.

**Further equipment available after consultation!**

\* Only for Europe (LTE not for overseas export)



## DESIGN



Ready to go: Your Caravanboat is always ready to go wherever you want to go.

Your Caravanboat delivers on your highest expectations through extravagance in performance and design. The next few pages highlight the standard options and features already included in your Caravanboat at delivery ex works. Please let us know, if you require any further amenities. We are happy to oblige.

Ahoy!

## TECHNICAL SPECIFICATIONS\*

	M		L & XL
LOA ca. (excl. engine)	23' (6,90 m)		26.2' (7,90 m)
Hull total / over all	7.7/8.0' (2,35/2,45m)		7.7/8.0' (2,35/2,45m)
Draught	5.9 – 9.0' (0,15 – 0,25m)		5.9 – 9.0" (0,15 – 0,25m)
Tara / Unladen weight*	3,527 lbs (1.600kg)		3,968 lbs (1.800kg)
Load capacity water/land	6 people 2,200 lbs (1000kg)		6 people (CAT C 5 people) 1100 lbs (500kg)
Fuel Aluminium tank (petrol)	26.4 gal (UK) / 31.7 gal (US) (ca. 120l.)		26.4 gal (UK) / 31.7 gal (US) (ca. 120l.)
Fresh & waste water tanks	each 18.5 gal (UK) / 18.4 gal (US) (a` 70l.)		each 35.2 gal (UK) / 42.3 gal (US) (a` 160l.)
Headroom	6.4' (195cm)		6.4' (195cm)
Open cabins	2		2
Bathroom	1		1
Beds (bow) / size	2 single 2.3' x 6.6' (70 x 200cm) unfolded: 7.2' x 6.6' (220 x 200cm)	or	2 single 2.3' x 6.6' (70 x 200cm) or unfolded: 7.2' x 6.6' (220 x 200cm)
Bed (roof) optional			1 pop-top 4.3' x 6.6' (130 x 200cm)
Bed (rear) / size	1 table convertible into 3.3' x 6.6' bed (100 x 200cm bed)		1 table convertible into 3.3' x 6.6' bed (100 x 200cm bed)
Steering	hydraulic		hydraulic
Gas bottle	5kg with Aluminium box		5kg with Aluminium box
Parking heater	petrol 3,8kW		petrol 3,8kW
Depth gauge	Round instrument with mirror encoder		Round instrument with mirror encoder
Hour meter	Round instrument		Round instrument
Bow thruster (optional)	Electrical / bow propeller extendable		Electrical / bow propeller extendable
Multifunctional display	power / water / pump / solar		power / water / pump / solar / temperature / USB charger
Permitted maximum speed	8kn		10kn
Trailer 3.5t. specs:	25.1' x 7.5' (7660mm x 2300mm) / 1142 lbs (654 kg)		28.5' x 7.5' (8700 x 2300mm) / 1618 lbs (734kg)
Trailer 3.5t. features:	62 mhp (100 km/h), optional alloy rims, anti-snaking hitch		62 mph (100 km/h), optional alloy rims, anti-snaking hitch
Vertical load trailer coupling	286 lbs (130kg)		353 lbs (160kg)

\* Depending on the equipment

\* All figures are estimate



## STANDARD FEATURES

### EXTERIOR

#### Hull

Flat catamaran aluminum sea waterproof  
Antifouling with red water pass  
Bow and side 2.7" x 2.7" (7 x 7cm) rubber curbing  
Additional installation level behind the baseboard

#### Superstructure

RexWall™ GfK Sandwich insulated to 0.2" (40mm)  
High gloss RAL9016 with high quality matt foil

#### Helm

Stainless steel steering wheel  
Depth gauge and operating counter  
Instrument LED switch console  
Central for 12V fuse  
Expandable for display devices

#### Deck

6 stainless steel cleats  
Rear railing made of polished stainless steel  
Stainless steel swim ladder with climbing handles  
Non-slip roof in Telegrey, 1100 lbs (300kg) max. load

#### Side Windows

Insulated, insect screen, grey shades

#### Bow and Stern Windows

0.2" – 0.3" (6 – 8mm) plastic, grey tinted

#### Additional Features

Stainless steel ladder on bow and stern railing  
Aluminum checker plate flooring on lower deck  
Searchlight with remote control, grill

### INTERIOR

#### Bow Cabin

Cold foam mattresses/pillows  
Velour standard, sisal fabrics optional  
Reading lights, Beverage holder by the bed  
Insulated blackout with magnets

#### Bathroom

Incineration toilet  
Shower with teak floor  
Mirror cabinet  
shower blind

#### Salon

Wood imitation plain, application grey/brown  
Table convertible to bed  
Height-adjustable dining table  
Heating pipe in seat  
Ambilight RC as option  
Benches with storage flap  
Ambilight over bench seats  
Roof box 5x with fall arrest bar

#### Kitchen

Wood imitation plain, application grey/brown  
2-burner gas stove and sink  
230V socket, USB plug Ultimate  
Refrigerator with ice compartment  
2 LED "onetouch" ceiling spotlights

#### Wall/Floor

Fleece available in grey, dark grey and beige colors  
Interior laminate strips, laid individually

#### Climate on the rear wing

Ambilight, cool, heat, dehumidify

### SYSTEM

#### Water Supply

e-submersible pump; hot water 230V  
Hot water 230V cartridge and hot air

#### Bilge- and Wastewater Pump

Electrically switchable from the helm

#### Drive (option)

Prepared for petrol outboard motor  
15, 30, 60 hp or 12kW electric drive  
Higher performance possible on request

#### Electrical System

(UK/US systems on request)  
Separate engine and on-board power circuits  
Batteries start 50Ah, 120Ah thruster,  
150 - 300Ah board  
Shore power connection 230V CEE  
Battery charger (3 channels), Bluetooth  
TV 32" Smart with swiveling bracket

#### Navigation

Top anchor light LED  
Position lights RINA + NMMA-USA  
Single horn, reversing lights

#### Heating

Fuel 3,8kW with remote

#### Certification

CE certificate category D  
(inland water ways)



## MEGA PANORAMA



## Layout M & XL

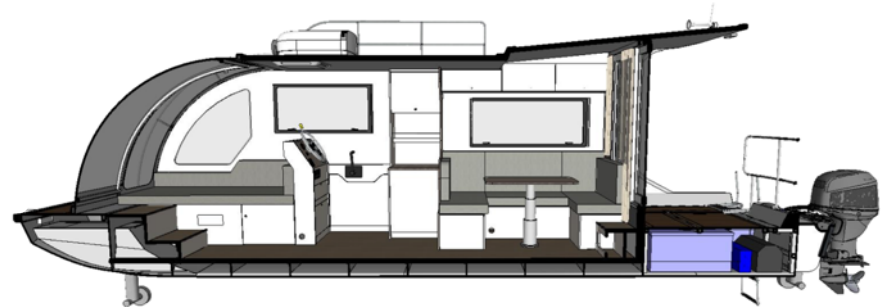
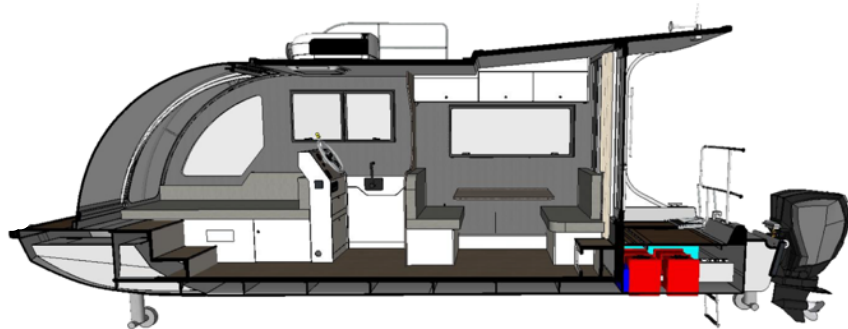
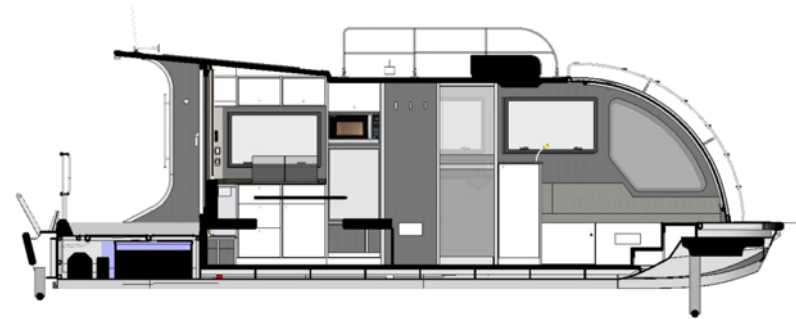

## Layout L

# terrace size like M  
# 60cm longer inside

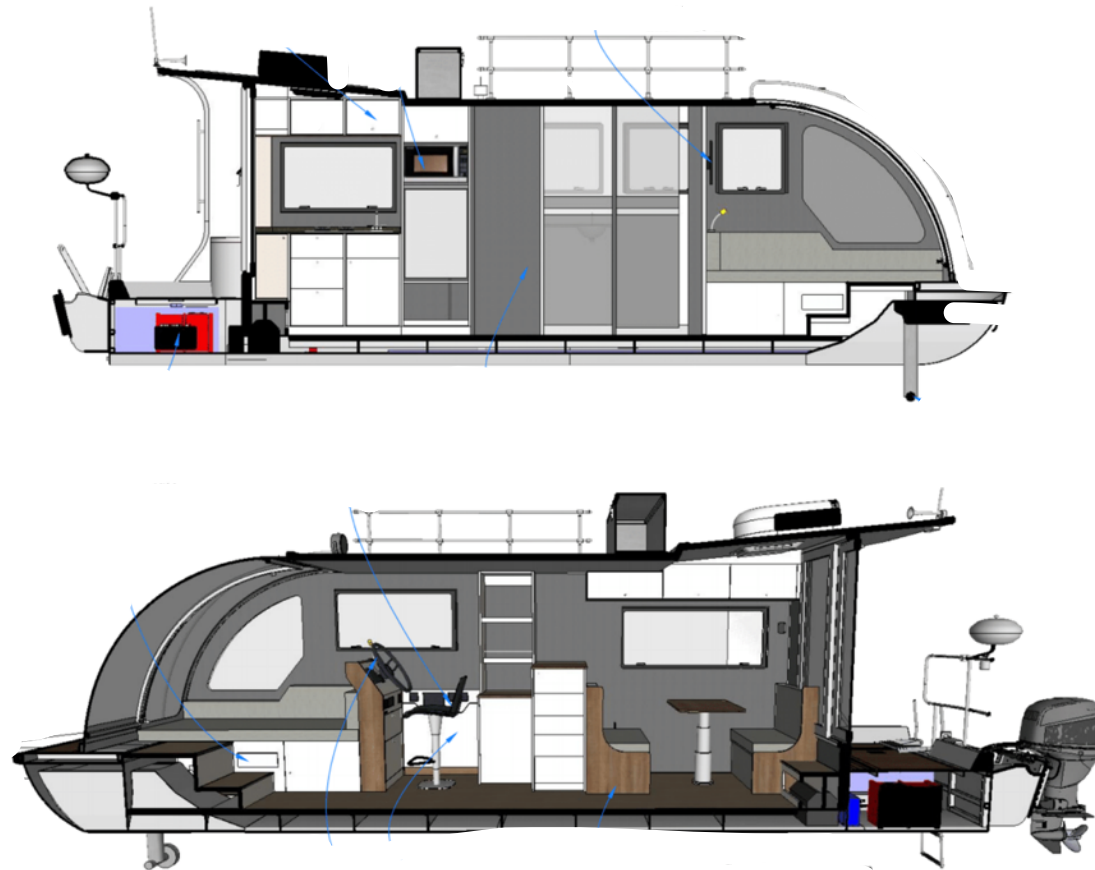



## ALL IN ONE

SPORTS BOAT / HOUSEBOAT / CARAVAN / TINY HOUSE



Copyright ©

Copyright Deutsche Composite GmbH, Hamburg. All rights reserved. Text, images, graphics, sound, animations and videos as well as their arrangement on the website are subject to copyright protection and other protective laws. The content of these texts may not be copied, distributed, modified or used for commercial purposes or made available to third parties



Visit us on Facebook and join our group ([caravanboat/group](https://www.facebook.com/caravanboat/group))!  
Become a part of our community and be the first to get inside information!



Deutsche Composite GmbH (Holding), Grosse Strasse 117A, D-21075 Hamburg, Germany, Head Office: +49 40 76116195, Sales: +49 172 419 72 84, [www.caravanboat.de](http://www.caravanboat.de), [info@caravanbaot.de](mailto:info@caravanbaot.de)

All prices quoted are in EURO and are only valid in connection with and at the time of ordering a new DepartureOne ex works (EXW). All dimensions and weights are calculated values based on design documents. The brochure is for promotional purposes only and does not form part of any contract, warranty or offer. Our products are subject to continuous development, so technical data, specifications or equipment may change without notice. We assume no liability for errors and misprints. The above prices are recommended retail prices for factory delivery within four months of order placement. For later delivery dates, we reserve the right to charge according to the applicable price list. 30% prepayment and according to construction progress. Delivery time 6 – 8 months.

Edition: 2023, V5

Valid from: 01 September 2023