





Vessel Prices

| Optional features | Deck Cover Plastic | Padding selection | TV 32` LTE | Thruster Remote | A/C | Incineration toilette or Dry toilette | Outdoor shower | Solar 160W | Lithium Charger | Shading Isolate bow area | Net ex. VAT |
|---------------------------------|--------------------------|----------------------|---------------|--------------------|-----|---|-------------------|---------------|--------------------|--------------------------------|-------------|
| DepartureOne M Basic | ✓ | 1 | - | - | - | D | - | - | 100Ah | - | 141.176,47 |
| DepartureOne M Premium | ✓ | 1 | ✓ | 180° | - | D | - | 1x | 100Ah | ✓ | 150.420,17 |
| DepartureOne M Ultimate | ✓ | 2 | ✓ | 360°, R | ✓ | I | ✓ | 2x | 300Ah, 2xC | ✓ | 166.386,56 |
| DepartureOne XL Premium | ✓ | 1 | ✓ | 180° | - | D | - | 1x | 100Ah | ✓ | 158.823,53 |
| DepartureOne XL Ultimate | ✓ | 2 | ✓ | 360°, R | ✓ | I | ✓ | 2x | 300Ah, 2xC | ✓ | 183.193,28 |

All prices for vessels and additional features and all particulars given in this brochure are non-binding customer information, delivery ex works. All prices apply to individual vessels and are valid from 2024 – subject to change.

* Only for Europe (LTE not for overseas export)

OPTION/ UPGRADE

| ITEM | DESCRIPTION (approximate information) | Price EUR (€) Net ex. VAT |
|------|--|------------------------------|
| | 180° bow transverse rudder extendable, e-propeller | 4.200,00 |
| | 360° bow transverse rudder extendable, e-propeller / stern transverse rudder, e-propeller on outboard engine | 6.048,74 |
| | On-board battery lithium battery 300Ah, Bluetooth™, BMS, 2 chargers | 2.981,51 |
| | 2x solar panels walkable with regulator 320W | 3.527,73 |
| | 1x solar panels walkable with regulator 160W | 1.678,99 |
| | Combustion toilet 1.3A & 150g/gas (burns all faeces including liquids and paper) | 4.621,01 |
| | Searchlight with radio remote control (spot or scattered light function) | 1.050,42 |
| | Reversing light LED 6x3W beam angle 60° | 292,44 |
| | Small microwave can be operated in the roof box with a 230V shore power connection | 301,68 |
| | Combination microwave/grill/oven can be operated with a 230V shore power connection (XL version only) | 460,50 |
| | Auxiliary heater petrol Eberspächer B4L auxiliary heater 3.8kW | 4.200,00 |
| | Hot water system in conjunction with the auxiliary heater (230V or through warm air while driving) | 1.174,79 |
| | Air conditioning roof installation with heat pump, indirect lighting and remote control | 2.099,16 |
| | Remote controlled hydraulic steering | 3.779,83 |
| | TV 32 with LTE antenna | 2.175,63 |
| | Bow shore connection (second shore connection) | 1.090,76 |
| | Ambilight package (hull lighting and interior lighting blue) | 2.897,48 |
| | Winter package – heated water hoses 230V | 1.174,79 |
| | Exterior | |
| | Occupancy of upper deck (roof) horizontal surface plastic | 2.729,41 |
| | Outside water connection with hot and cold water mixer (for outdoor shower, water brush, etc.) | 335,29 |
| | Rear awning with piping on the rear wing | 495,80 |
| | 3 layer antifouling, also suitable for galvanic isolation, water pass red | 2.771,43 |
| | Roof railing horizontally | 1.258,82 |
| | Railing ladder bow, staircase to the roof | 2.099,16 |
| | Rolling keels (suppression of drift) | 1.300,84 |
| | Second gas container rear STB (gas bottle, trash can or storage space) | 376,47 |
| | Gas grill for CV470 cartridges | 460,50 |

OPTION / UPGRADE

| ITEM | DESCRIPTION (approximate information) | Price EUR (€) Net ex. VAT |
|--------------------------------------|--|------------------------------|
| Interior | | |
| | Blackout bow and bow side windows | 1.562,18 |
| | Room divider with ceiling rail (curtain) | 250,42 |
| | Blackout rear (curtain) | 250,42 |
| | Captain swivel chair in black genuine leather | 729,41 |
| | iPad holder for navigation | 33,61 |
| | iPhone holder | 25,20 |
| | Clothes hook V4A foldable. Set of 6 pieces placed according to customer requirements | 65,55 |
| SUV or small van trailer | | |
| | Aluminum including slip aid, supports, straps etc. | 16.805,04 |
| | Stainless steel V2A including slip aid, supports, straps etc. | 9.141,78 |
| | Galvanized steel including straps etc. | 8.401,68 |
| | Anti-sway clutch | 571,43 |
| | Support setting customized 90 – 120kg range | 502,52 |
| | Dynamic LED taillights | 626,05 |
| | Storage box | 209,24 |
| Antrieb | | |
| | Suzuki 15HP including installation, hydraulic steering, trim etc. | 4.536,14 |
| | Suzuki 30HP including installation, hydraulic steering, trim etc. | 6.300,84 |
| | Suzuki 60HP including installation, hydraulic steering, trim etc. | 9.242,86 |
| | Torqueedo e-drive including installation, hydraulic steering, trimming etc. | Inquiry |
| | Rudder display on the steering position | 1.049,58 |
| Special components on request | | |
| | Wheelhouse door | 4.285,71 |
| | Remote controlled steering | Inquiry |
| | Lifting roof (XL only) | 7.393,28 |

Electric drive 12 KW

Travel speed at 2kW
Power consumption
approx. 8 km / h

Range slow drive: approx.
6 hours

- In case of
windspeed and
water flow

DESIGN



Ready to go: Your Caravanboat is always ready to go wherever you want to go.

Your Caravanboat delivers on your highest expectations through extravagance in performance and design. The next few pages highlight the standard options and features already included in your Caravanboat at delivery ex works. Please let us know, if you require any further amenities. We are happy to oblige.

Ahoy!

TECHNICAL SPECIFICATIONS*

| | M | | XL |
|--------------------------------|--|----|---|
| LOA ca. (excl. engine) | 23' (7,00 m) | | 26.2' (8,00 m) |
| Hull total / over all | 7.7/8.0' (2,35/2,45m) | | 7.7/8.0' (2,35/2,45m) |
| Draught | 5.9 – 9.0' (0,15 – 0,25m) | | 5.9 – 9.0" (0,15 – 0,25m) |
| Tara / Unladen weight | 3,527 lbs (1.600kg) | | 3,968 lbs (1.800kg) |
| Load capacity water/land | 6 people 2,200 lbs (1000kg) | | 6 people (CAT C 5 people) 1100 lbs (500kg) |
| Fuel Aluminium tank (petrol) | 26.4 gal (UK) / 31.7 gal (US) (ca. 120l.) | | 26.4 gal (UK) / 31.7 gal (US) (ca. 120l.) |
| Fresh & waste water tanks | each 18.5 gal (UK) / 18.4 gal (US) (a' 70l.) | | each 35.2 gal (UK) / 42.3 gal (US) (a' 160l.) |
| Headroom | 6.4' (195cm) | | 6.4' (195cm) |
| Open cabins | 2 | | 2 |
| Bathroom | 1 | | 1 |
| Beds (bow) / size | 2 single 2.3' x 6.6' (70 x 200cm) unfolded: 7.2' x 6.6' (220 x 200cm) | or | 2 single 2.3' x 6.6' (70 x 200cm) or unfolded: 7.2' x 6.6' (220 x 200cm) |
| Bed (roof) optional | | | 1 pop-top 4.3' x 6.6' (130 x 200cm) |
| Bed (rear) / size | 1 table convertible into 3.3' x 6.6' bed (100 x 200cm bed) | | 1 table convertible into 3.3' x 6.6' bed (100 x 200cm bed) |
| Steering | hydraulic | | hydraulic |
| Gas bottle | 5kg with Aluminium box | | 5kg with Aluminium box |
| Parking heater | petrol 3,8kW | | petrol 3,8kW |
| Depth gauge | Round instrument with mirror encoder | | Round instrument with mirror encoder |
| Hour meter | Round instrument | | Round instrument |
| Bow thruster (optional) | Electrical / bow propeller extendable | | Electrical / bow propeller extendable |
| Multifunctional display | power / water / pump / solar | | power / water / pump / solar / temperature / USB charger |
| Max. speed | 21kn | | 21kn |
| Trailer 3.5t. specs: | 25.1' x 7.5' (7660mm x 2300mm) / 1142 lbs (654 kg) | | 28.5' x 7.5' (8700 x 2300mm) / 1618 lbs (734kg) |
| Trailer 3.5t. features: | 62 mhp (100 km/h), optional alloy rims, anti-snaking hitch | | 62 mph (100 km/h), optional alloy rims, anti-snaking hitch |
| Vertical load trailer coupling | 286 lbs (130kg) | | 353 lbs (160kg) |

* All figures are estimate



STANDARD FEATURES Option*

EXTERIOR

Hull

Flat catamaran aluminum sea waterproof
Antifouling with red water pass
Bow and side 2.7" x 2.7" (7 x 7cm) rubber curbing
Additional installation level behind the baseboard

Superstructure

RexWall™ GfK Sandwich insulated to 0.2" (40mm)
High gloss RAL9016 with high quality matt foil

Helm

Stainless steel steering wheel
Depth gauge and operating h counter
Instrument switch console

Deck

4 stainless steel cleats
Rear railing made of polished stainless steel
Stainless steel swim ladder with climbing handles
Non-slip roof in Telegrey, 1100 lbs (300kg) max. load

Side Windows

Insulated, insect screen, grey shades

Bow and Stern Windows

0.2" – 0.3" (6 – 8mm) plastic, grey tinted

Additional Features

Stainless steel ladder* on bow and stern railing
Aluminum checker plate flooring on lower deck
Searchlight with remote control*, grill*

INTERIOR

Bow Cabin

Cold foam mattresses/pillows
Velour standard, sisal fabrics optional
Reading lights, Beverage holder by the bed
Insulated blackout with magnets*

Bathroom

Dry toilet or Incineration toilet*
Shower with teak floor
Mirror cabinet
shower blind

Salon

Wood imitation plain, application grey/brown
Height-adjustable dining table
Heating pipe in seat
Benches with storage flap
Ambilight over bench seats
Roof box 5x with fall arrest bar

Kitchen

Wood imitation plain, application grey/brown
2-burner gas stove and sink
230V socket, USB plug Ultimate
Refrigerator with ice compartment
2 LED "onetouch" ceiling spotlights

Wall/Floor

Fleece available in grey, dark grey and beige colors
Interior laminate strips, laid individually

Climate on the rear wing

Ambilight, cool, heat, dehumidify

SYSTEM

Water Supply

e-submersible pump; hot water 230V
Hot water 230V cartridge and hot air*

Bilge- and Wastewater Pump

Electrically switchable from the helm

Drive*

Prepared for petrol outboard motor
15, 30, 60 hp or 12kW electric drive
Higher performance possible on request

Electrical System (UK/US on request)

Separate engine and on-board power circuits
Batteries start 50Ah, 120Ah thruster, xAh board
Shore power connection 230V CEE
Battery charger (3 channels), Bluetooth
TV 32" Smart with swiveling bracket*

Navigation

Top anchor light LED
Position lights RINA + NMMA-USA
Single horn, reversing lights*

Heating

Fuel 3,8kW air system with remote*

Certification

CE certificate category D
(inland water ways)

MEGA PANORAMA



Floor plans M & XL

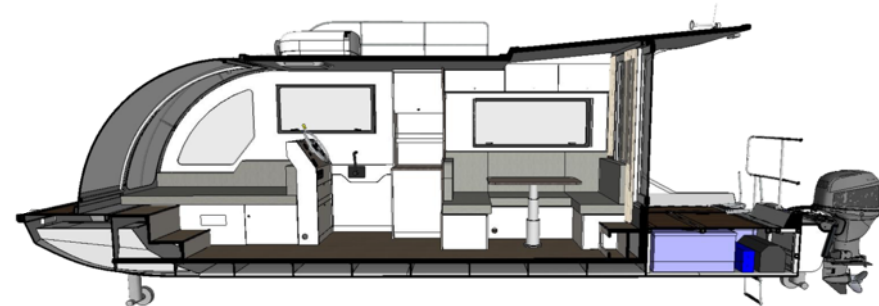
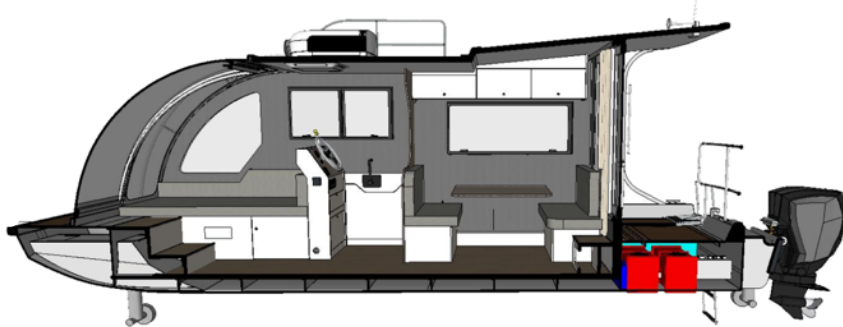
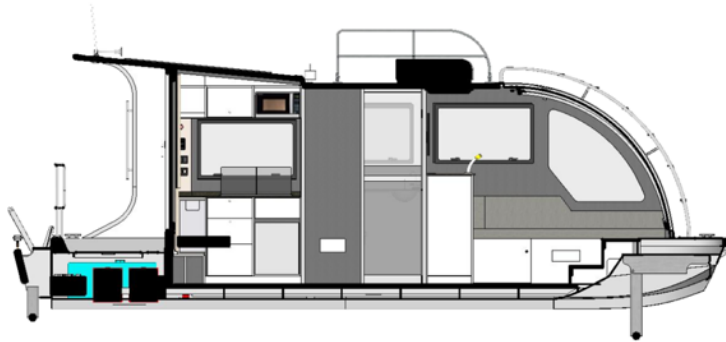

Floor plan L

(Patio size like M)

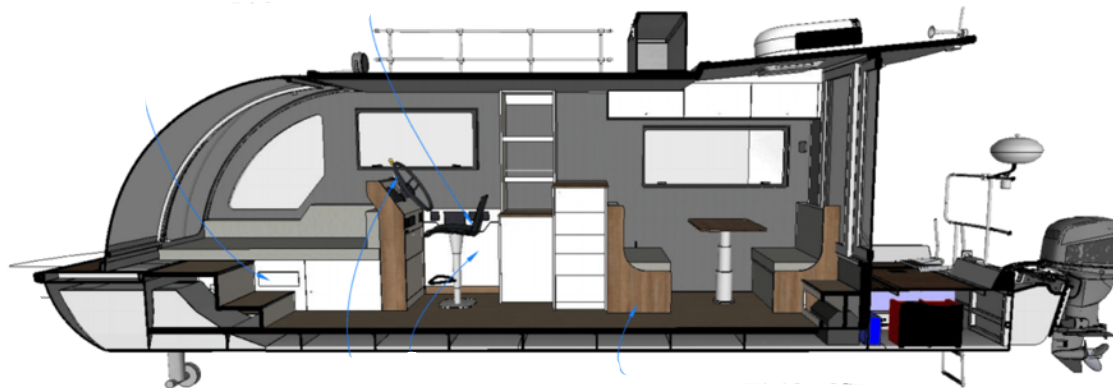
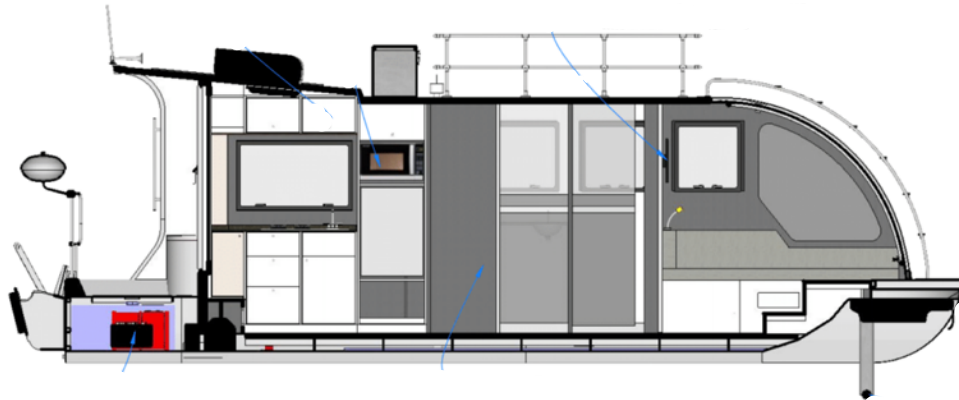

ALL IN ONE

SPORTS BOAT / HOUSEBOAT / CARAVAN / TINY HOUSE



Copyright ©

Copyright Deutsche Composite GmbH, Hamburg. All rights reserved. Text, images, graphics, sound, animations and videos as well as their arrangement on the website are subject to copyright protection and other protective laws. The content of these texts may not be copied, distributed, modified or used for commercial purposes or made available to third parties



Visit us on Facebook and join our group (caravanboat/group)!
Become a part of our community and be the first to get inside information!



Deutsche Composite GmbH (Holding), Grosse Strasse 117A, D-21075 Hamburg, Germany, Head Office: +49 40 76116195, Sales: +49 172 419 72 84, www.caravanboat.de, info@caravanbaot.de

All prices quoted are in EURO and are only valid in connection with and at the time of ordering a new DepartureOne ex works (EXW). All dimensions and weights are calculated values based on design documents. The brochure is for promotional purposes only and does not form part of any contract, warranty or offer. Our products are subject to continuous development, so technical data, specifications or equipment may change without notice. We assume no liability for errors and misprints. The above prices are recommended retail prices for factory delivery within four months of order placement. For later delivery dates, we reserve the right to charge according to the applicable price list. 30% prepayment and according to construction progress. Delivery time 6 – 8 months.

Edition: 2024, V1

Valid from: 01 January 2024